

ANALOG SWITCHBOARD METERS

INDUSTRIAL SWITCHBOARD METERS

MODEL HLS110

FEATURES

4 1/2" SQUARE

- Designed for industrial use - strong plastic case with rugged mounting studs and electrical terminals.
- Sealed cover and case - maintains accuracy and prolongs life.
- $\pm 1.0\%$ Accuracy - meets or exceeds ANSI C39.1 specifications.
- Frequency range: 45-65Hz.
- Easy to read at a distance or angle - bold clean dials; no shadows; no parallax error; attractive, uncluttered scales.
- Shielding of mechanisms ensures against magnetic field and steel panel mounting problems.
- Two piece dial and picket pattern. D'Arsonval movements are linear and repeatable to one percent on preprinted dials.



RANGE	CATALOG NO.
AC VOLTMETERS, RMS Responding, self-contained	
0-150	HLS110-150V150V
0-250	HLS110-250V250V
0-300	HLS110-300V300V
0-500	HLS110-500V500V
0-600	HLS110-600V600V
AC VOLTMETERS, RMS Responding, 150V Rated external potential transformers required.	
0-300	HLS110-150V300V
0-600	HLS110-150V600V
0-600	HLS110-250V600V
0-750	HLS110-150V750V
0-3000	HLS110-150V3000V
0-5250	HLS110-150V5250V
0-6000	HLS110-150V6000V
0-9000	HLS110-150V9000V
0-15K	HLS110-150V15KV
0-18K	HLS110-150V18KV
0-45K	HLS110-150V45KV
0-150K	HLS110-150V150KV
AC AMMETERS, RMS Responding, 5A rated, external current transformer required	
0-50	HLS110-5A50A
0-100	HLS110-5A100A
0-150	HLS110-5A150A
0-200	HLS110-5A200A
0-250	HLS110-5A250A
0-300	HLS110-5A300A
0-400	HLS110-5A400A
0-500	HLS110-5A500A
0-600	HLS110-5A600A
0-800	HLS110-5A800A
0-1000	HLS110-5A1000A
0-1200	HLS110-5A1200A
0-1500	HLS110-5A1500A
0-1600	HLS110-5A1600A
0-2000	HLS110-5A2000A
0-2500	HLS110-5A2500A
0-3000	HLS110-5A3000A
0-4000	HLS110-5A4000A
0-5000	HLS110-5A5000A
0-6000	HLS110-5A6000A

DIMENSIONS

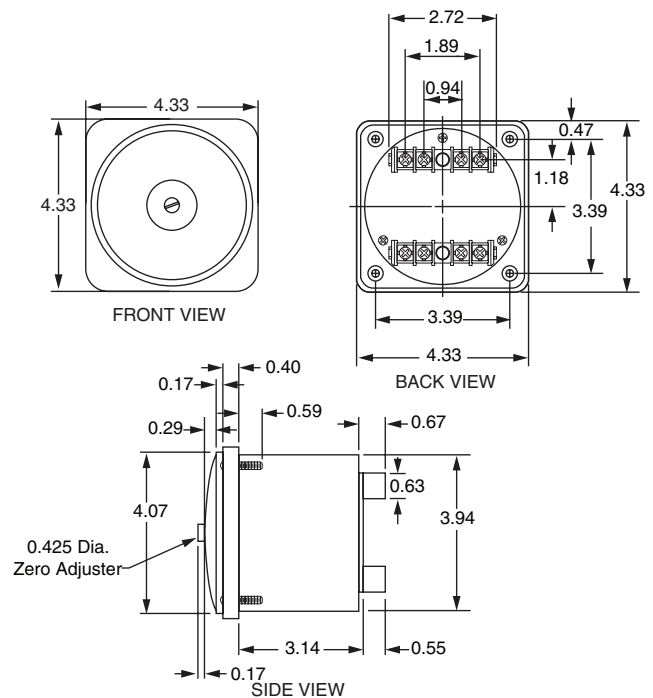

MOUNTING

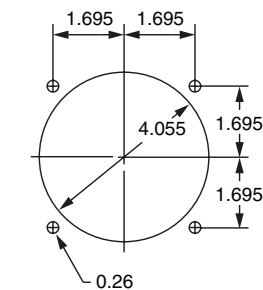

All Dimensions In Inches

ANALOG SWITCHBOARD METERS

FLEX-CORE®

Div. Morlan & Associates, Inc.

4970 Scioto Darby Rd. Hilliard, Ohio 43026

WWW.FLEX-CORE.COM

sales@flex-core.com

PHONE (614) 889-6152

TECH. ASSISTANCE (614) 876-8308

FAX # (614) 876-8538